



STUDENTS



WE ARE OPEN!





CONTENTS

1. WE ARE OPEN! WELCOME TO THE 'RONDON' BUILDING	3
2. LAYOUT OF THE BUILDING	4
3. STUDYING AND RESEARCH IN THE RONDON BUILDING	6
4. LOCATION, CONTACT, AND ACCESSIBILITY	8
5. FACILITIES AND SERVICES	11
6. FOOD AND DRINKS	14
7. MAPS	16
8. SIGNING	22
9. QUESTIONS	23

WELCOME TO THE 'RONDON'

The 'Rondon', located at the TU/e campus in Eindhoven, is your new study location. It is an open, multifunctional and future-proof learning and working environment for all study programmes within Fontys' three technology institutes: Engineering (ENG), Applied Sciences (TNW), and Business management, Education and Technology (BEnT). At the Rondon Technology & Innovation (T&I), beautiful things come into being. Here, students, instructors and the professional field come together to solve technological issues, to take action with courage, and to search for creative solutions and forms of cooperation. Meeting, cooperating, and sharing knowledge play a key role in all of Fontys' technical study programmes.

HOME BASE

The building has six floors, including a cellar. All floors have their own Meeting Zone, including a study plaza with various facilities, such as coffee corners and places to sit and talk. Every study programme has its own home base with its own facilities. In addition, there are general facilities such as the bistro and the event room. The Education zones are more tranquil. At the heart of the building lies a dynamic atrium with practical training rooms located around it.

GETTING FAMILIARIZED WITH THE 'RONDON'

We are happy to welcome you to the Rondon. This guide will help you find what you are looking for in this beautiful building faster. Here you can find maps, information on facilities, opening hours, signposting, pictograms, and agreements on how we use the building.

This new environment and study location will probably take some getting used to. And some things may perhaps not be clear right away, or may not work properly yet. We would like to hear about the problems you encounter, so we can try to find a solution for them. So please do not hesitate to ask questions and tell us anything you notice. You can do so via your own institute's service desk.

Have fun with your studies!





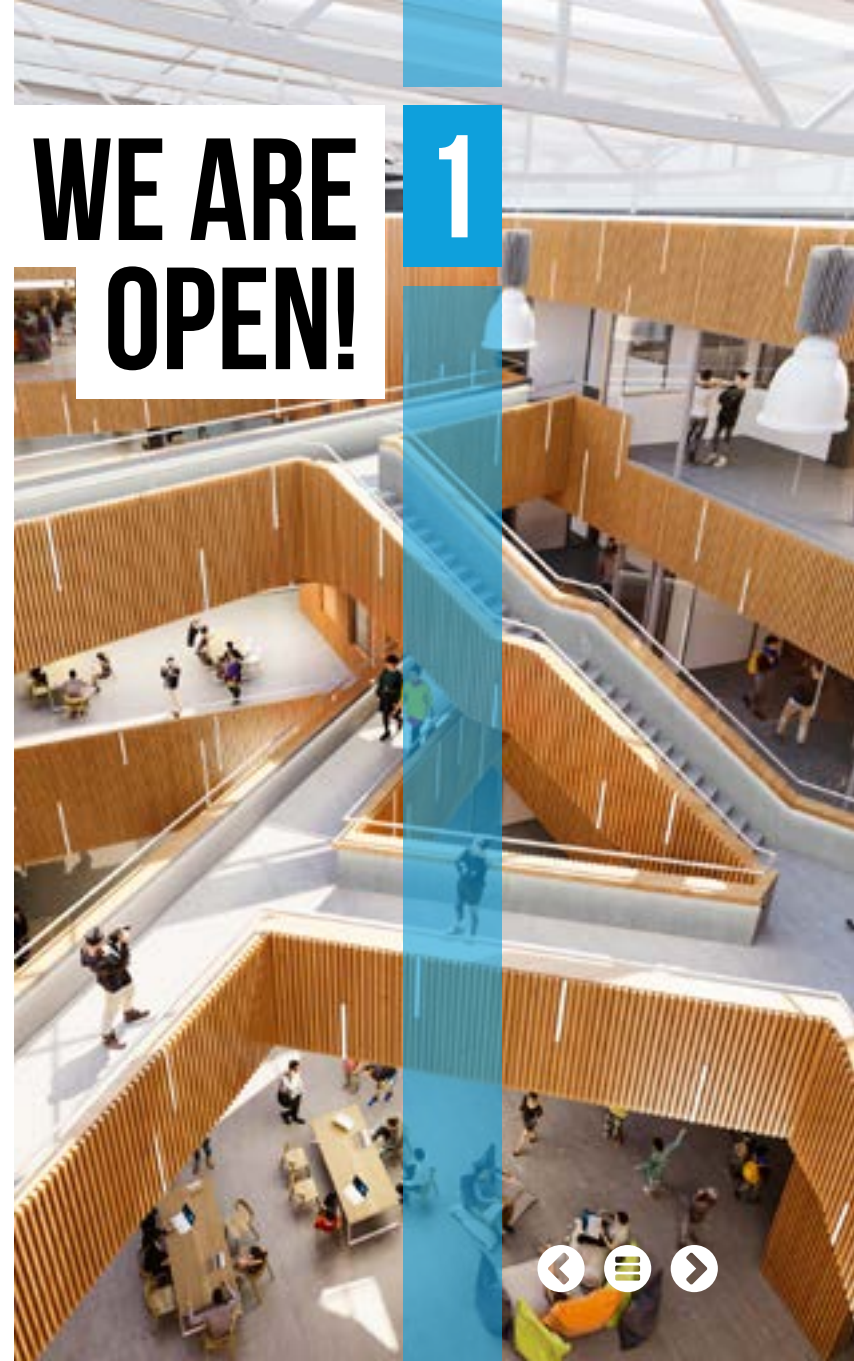

WE ARE OPEN!

1



2

LAYOUT OF THE BUILDING

-  SERVICE & INFORMATIONPOINT
-  SERVICEDESK ENGINEERING
-  SERVICEDESK TOEGEPASTE NATUURWETENSCHAPPEN
-  SERVICEDESK BEDRIJFSMANAGEMENT EDUCATIE & TECHNIEK
-  STAIRS
-  RESTROOM
-  DISABLED RESTROOM
-  BAR & BISTRO
-  ELEVATOR

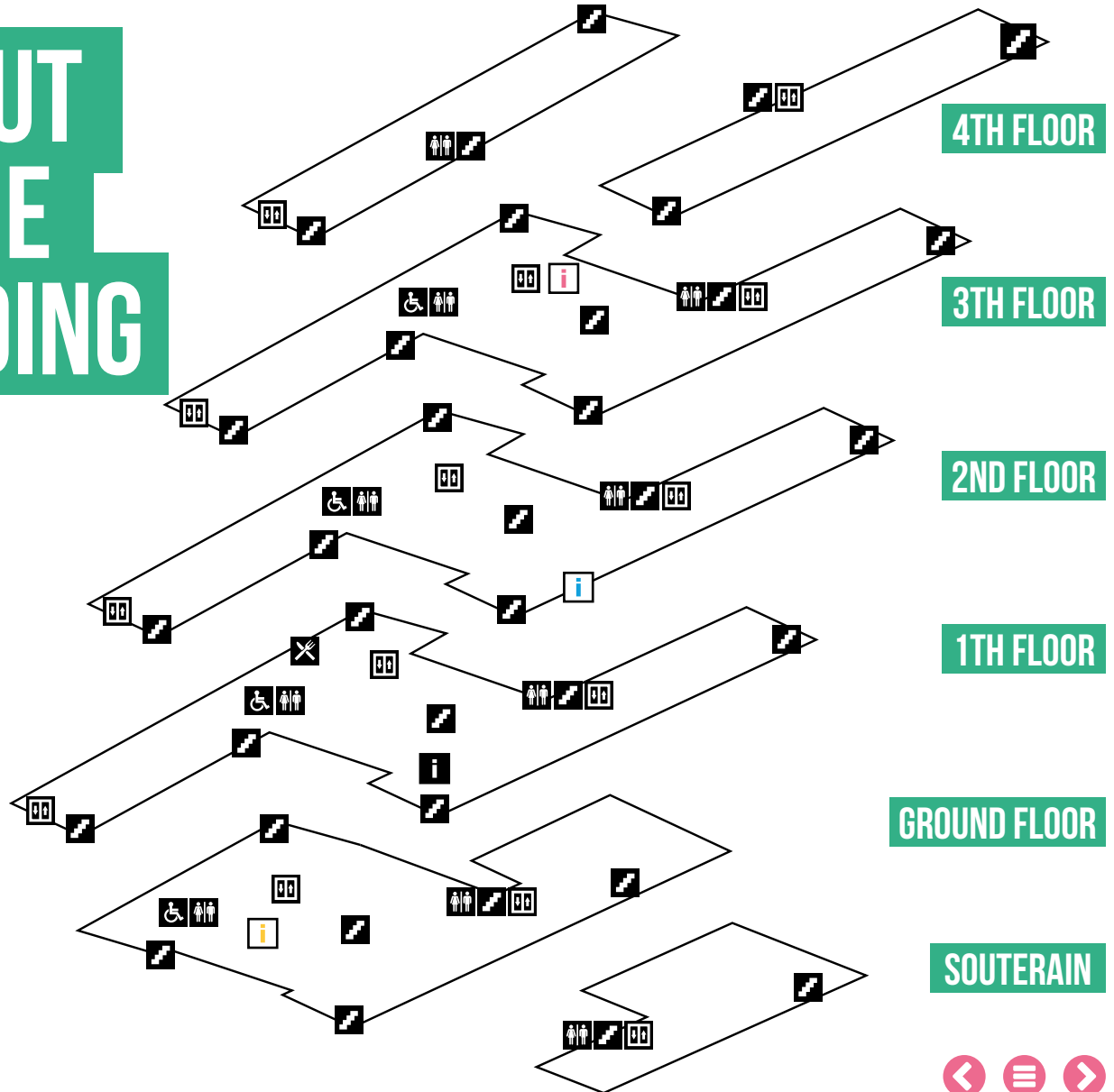

4TH FLOOR

3TH FLOOR

2ND FLOOR

1TH FLOOR

GROUND FLOOR

SOUTERRAIN



SOUTERAIN

Automotive Engineering Labs
Automotive Management Labs

GROUND FLOOR

Automotive
Electrical and Electronic Engineering
Elektrotechniek
Mechanical Engineering
Mechatronica
Mechatronics
Werktuigbouwkunde
Lectoraat Mechatronics & Robotics
Lectoraat Future Power Train
Service Desk

FIRST FLOOR

Centre of Expertise High Tech Systems & Materials
Centrum voor Ondernemerschap
Onderzoeksgroep Additive Manufacturing
Lectoraat Applied Natural Sciences
Onderzoeksgroep Distributed Sensor Systems
Lectoraat Smart Manufacturing

2ND FLOOR

Applied Science
Summa Laboratorium
Technische Natuurkunde
Service Desk

3TH FLOOR

Automotive Management
Bedrijfsmanagement MKB
Technische Bedrijfskunde
Industrial Engineering & Management
Leraar Technisch Beroepsonderwijs
Leraar Consumptieve Techniek
Lectoraat Business Entrepreneurship
Service Desk

4TH FLOOR

Innovation space
Lecture Hall



STUDYING AND RESEARCH IN THE RONDON BUILDING

In the Rondon there are different types of rooms. There are rooms for education, staff rooms and other rooms, e.g. for meeting up, recreation and events. All the rooms are accessible to everyone and are not locked. With the exception of the rooms where:

- specific operational and safety requirements apply (labs, engineering workshops, etc.).
- personal belongings of staff are stored and no personal lockers are available.

On the above map you can see on which floor your study programme takes place. Every institute and study programme has its own agreements and practices. That is why you can find a separate attachment in this guide for each study programme. Here you can find more information about workstations and safety, and more.

STUDY PLAZAS

A study plaza is an open space where you can work as well as relax. There are several study plazas in the building. All study plazas are accessible for everyone, with the exception of plazas to which specific safety requirements for users apply. There are various types of study plazas:

- Quiet study plazas where people can work in peace and quiet. These rooms are always available and do not have a timetable.
- Project plazas; these plazas can be booked via the timetable and are meant for group work on projects.
- Multifunctional plazas where various activities take place, such as discussions, group work and project work. These rooms are always available as well, and do not have a timetable.

The signposting in the building clearly indicates where each plaza is located, whether it has restricted access and which agreements apply in it.

WORKING AND LEARNING ENVIRONMENT FOR STUDENTS

On the study plazas you will find study areas with and without presentation screens. There are also various discussion and project rooms in the Rondon. You can book these rooms on the floor of your study programme via WebUntis. For instructions, see the link below:
<https://rooster.fontys.nl/WebUntis/?school=Fontys-rondon>

CONFERENCE ROOMS

There are various types of conference rooms in the Rondon building. These can be used by both staff and students. Some conference rooms are assigned to a specific study programme. These rooms can only be booked by that particular study programme.

The following applies to the other conference rooms: all users of the Rondon Building can use these rooms on the day itself providing they have not been booked by anyone else. A sign at the conference room clearly indicates what type of conference room it is. In the attachment you will find more information on booking and using the rooms delegated to your own study programme.



4

LOCATION, CONTACT, AND ACCESSIBILITY

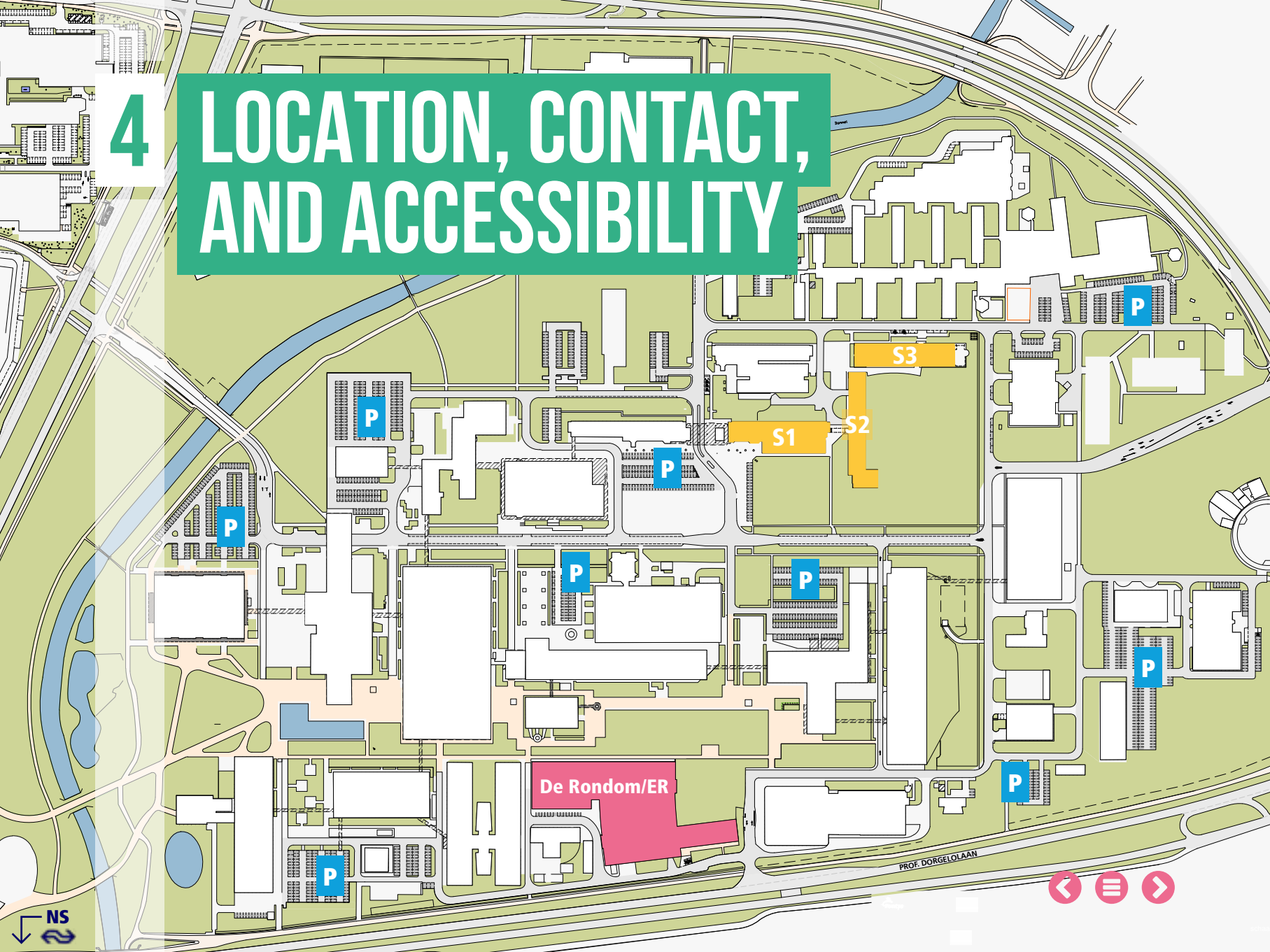

VISITING ADDRESS:

De Rondon 1, 5612 AP in Eindhoven

POSTAL ADDRESS:

Fontys University of Applied Sciences

Attn.; (institute, name, room number)

P.O. Box 347

5600 AH Eindhoven, The Netherlands

Telephone number: + 31 (0)8850 73533

OPENING HOURS OF THE RONDON BUILDING

The course hours determine the opening hours of the building.

Monday, Tuesday and Thursday from 07:30 a.m. to 10:00 p.m.

Wednesday and Friday from 07:30 a.m. to 6.15 p.m.

In the weeks during which there are no educational activities, the building is open from 08:00 a.m. to 5.00 p.m.

Opening hours of the TU/e premises:
the premises are open 24/7. Of course this does not apply to the services.



ACCESSIBILITY

• Public transport:

The TU/e Campus is located in the centre of Eindhoven, approximately an eight minutes' walk from Eindhoven Central Station. It is therefore easy to travel here by public transport.

• Car:

The TU/e Campus is accessible by car via the three entrances:

- John F. Kennedylaan
- Insulindelaan
- Prof. Dr. Dorgelolaan

The entrances are closed by barriers. These barriers open by number plate registration. However, you do need to register beforehand. Below you will find how to do so.

There are multiple car parks at the campus. (At the Rondon building, there are also a few disabled parking spaces.)

PAID PARKING

Are you planning on travelling to your new study location by car? Do keep in mind that all Fontys students and Fontys staff will have to pay for parking at the TU/e campus as of 1 September 2019. To curb the extremely high parking pressure, the TU/e has opted to apply its parking policy to all the other organisations located on the TU/e campus.

- **Registration for parking at a reduced fee:**

Just like the TU/e, we are also going to use the (H)Eerlijk Parkeren payment system at the TU/e campus, with which staff and students benefit from a reduced fee. If you use the (H)Eerlijk Parkeren payment system, you pay €3.50 per day for parking at the TU/e campus. Your registration involves two steps:

- Step 1: register via fontysconnect.nl/betaaldparkeren, follow all the steps and confirm your registration. Please note: you need your Fontys pass for this.
- Step 2: activate your account at www.heerlijkparkeren.nl and fill up the balance in your account. Please note: this is possible from 30 August onwards. For more information about (H)eerlijk Parkeren, see: www.heerlijkparkeren.nl/hoe-werkt-het.

More information on paid parking can be found at fontysconnect.nl/betaaldparkeren

- **Bicycle:**

It is healthier and more sustainable to go to Fontys by bicycle. A bike parking facility is available for students who come by bike.

More information can be found on the website of the TU/e:
<https://www.tue.nl/universiteit/over-de-universiteit/bereikbaarheid-tue-campus/bereikbaarheid-route-en-plattegrond-tue-campus/naar-tue-campus/>



Nearly all facilities and amenities can be found in the Random building. If you need anything or would like to make use of something that is not available at the Random building (such as the copy shop), we kindly refer you to our Rachelsmolen campus.

SERVICE & INFORMATION POINT

There is a general Service & Information point on the first floor. You can ask all general questions on the Random building and its amenities here. But you can also ask all your IT and facility-related questions here. During opening hours someone will always be present.

SERVICE DESK AT EACH INSTITUTE FOR STUDENTS

Each institute has a Service Desk for students on its own floor.

ENG	ground floor
TNW	second floor
BEnT	third floor

In paragraph 2 you can see where your study programme is held.

IT HELP DESK

For all your IT-related questions you can consult the IT help desk at the central Service & Information point on the first floor.

Opening hours: Mon - Fri from 9.00 a.m. to 4.30 p.m., without appointment. You can schedule an appointment with one of our Decentralised Supporters (Decentrale Ondersteuners) between 8.30 a.m. and 5 p.m. They will check their agendas to see when there is a free spot. You can find more information at: <https://connect.fontys.nl/diensten/IT/Paginas/IT-Servicedesk.aspx>

FACILITIES AND AMENITIES

5



WASTE SEPARATION

Litter bins can be found in common areas of the building for three types of waste:

1. Plastic, metal, food/drink cartons
2. Paper
3. Non-recyclable waste

Any other questions about waste, for example how to discard glass or confidential papers, can be asked at the central Service & Information point. To discard hazardous substances, please contact the lab supervisor at your own institute.

COMMON LOCKERS

At various locations in the Rondon building you can find common lockers in which you can store your belongings for a short period of time. Everyone can make use of these lockers by means of their pass. Please note that these lockers must be emptied before the building is closed. For more information about these lockers (where they are and how they work), click on the following link:

<https://connect.fontys.nl/diensten/HenF/huisvesting-en-terrein/lockers>

SMOKING

Smoking is only allowed in the designated areas fitted with a smoking receptacle. In the course of 2020, the smoking ban in public places will come into force. The smoking receptacles will then be removed and smoking on the TU/e campus will no longer be allowed.

COPY SHOP

If you would like to print, copy, or bind documents, etc., you can use the facilities at the Rachelsmolen campus. The Rondon building does not have a copy shop.



ACCESSIBILITY FOR PEOPLE WITH DISABILITIES

The building is equipped with multiple elevators. There is a disabled toilet on every floor and there are special parking spaces. The Rondon building is wheelchair friendly.

QUIET ROOM

The quiet room can be entered freely during opening hours of the building. The room provides you with the opportunity to retire in silence for contemplation, meditation or prayer.



PANTRY

Each floor has one or more pantries where you can get coffee or tea.

SAFETY

Of course, safety in the building is a key item. All members of the first response teams of the study programmes have been specially trained and instructed in the context of safety in the new Rondon building.



The emergency exits have been indicated on the map in chapter 4. Various calamity instructions and escape routes will be displayed in clearly visible locations throughout the building.

ACCESSIBILITY

All rooms in the Rondon building are freely accessible unless the room needs to be locked for safety reasons.

6

FOOD AND DRINKS AT THE RONDON BUILDING

BISTRO + COFFEEBAR

The Rondon has a bistro and a coffeebar on the first floor. Here you can find:



Barista Coffee in the coffeebar in the lobby

Your favourite coffee made by our baristas. Besides coffee you can also go here for a broad selection of buns, hot snacks or a sweet snack. Opened Mon-Fri from 8.00 a.m. to 4 p.m.

Bistro

The Bistro is opened on Monday, Tuesday and Thursday from 11 a.m. to 8 p.m. and on Wednesday and Friday from 11.00 a.m. to 6.00 p.m. You can find the dinner times on the announcements in the restaurant.

Go italian

For fresh pizzas; choose from one of the creations or create your own pizza: meat, fish or vegetarian. We also highly recommend the freshly made pastas.

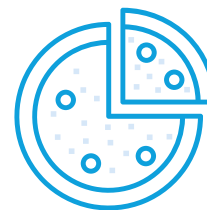

Healthy choices

Would you rather have something healthier? Then there is the self-service salad bar. Here you can mix & match your signature salad.



The Grill

Burgers, hot dogs, hot buns or French fries. All meat, or vegetarian if you prefer. Everything is home-made with high-quality ingredients and is prepared for you while you are waiting.

CONVIVIALITY AFTER STUDYING

Student bar The Dome is available for students and is openend from 2 p.m. Also staff is welcome here as well. This bar has a terrace. A place to get together in a pleasant way.



10

MAPS

SOUTERAIN

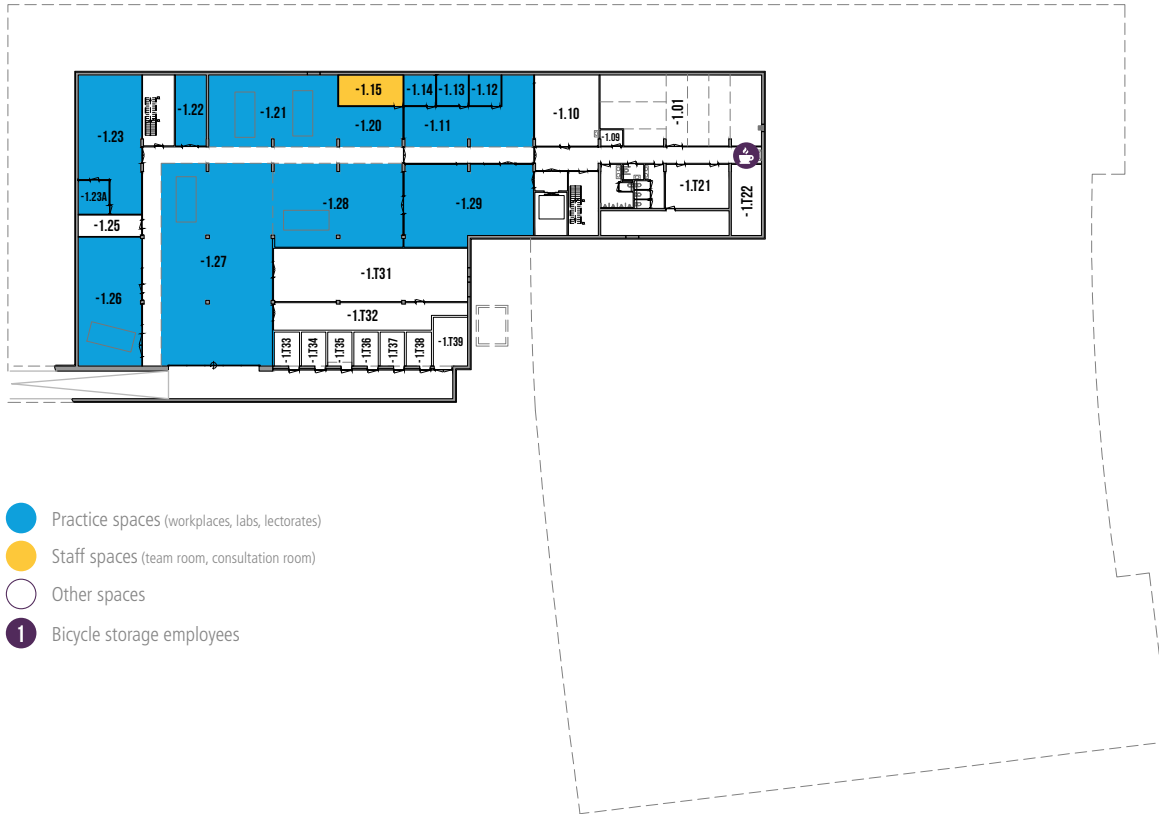

- Practice spaces (workplaces, labs, lectures)
- Staff spaces (team room, consultation room)
- Other spaces
- 1 Bicycle storage employees

GROUND FLOOR



1TH FLOOR



The floor plan shows a complex layout of rooms and corridors. The rooms are color-coded according to their function:

- Study and project spaces (pink):** 2.09, 2.23, 2.43, 2.45, 2.81, 2.79, 2.78, 2.77A, 2.77B.
- Practice spaces (workplaces, labs, lectorates) (blue):** 2.20, 2.19, 2.18, 2.17, 2.16, 2.15, 2.14, 2.13, 2.12, 2.11, 2.10, 2.08, 2.07, 2.06, 2.05, 2.04, 2.03, 2.02, 2.01, 2.28, 2.29, 2.30, 2.31, 2.40, 2.41, 2.42, 2.44, 2.46, 2.47, 2.48, 2.49, 2.50, 2.51, 2.52, 2.53, 2.54, 2.55, 2.56, 2.57, 2.58, 2.59, 2.60, 2.61, 2.62, 2.63, 2.64, 2.65, 2.66, 2.70, 2.71, 2.72, 2.73, 2.74, 2.75, 2.76, 2.77, 2.78, 2.79, 2.80, 2.81, 2.82, 2.83, 2.84, 2.85, 2.86, 2.87, 2.88, 2.89, 2.90, 2.91, 2.92, 2.93, 2.94, 2.95, 2.96, 2.97, 2.98, 2.99, 3.00, 3.01, 3.02, 3.03, 3.04, 3.05, 3.06, 3.07, 3.08, 3.09, 3.10, 3.11, 3.12, 3.13, 3.14, 3.15, 3.16, 3.17, 3.18, 3.19, 3.20, 3.21, 3.22, 3.23, 3.24, 3.25, 3.26, 3.27, 3.28, 3.29, 3.30, 3.31, 3.32, 3.33, 3.34, 3.35, 3.36, 3.37, 3.38, 3.39, 3.40, 3.41, 3.42, 3.43, 3.44, 3.45, 3.46, 3.47, 3.48, 3.49, 3.50, 3.51, 3.52, 3.53, 3.54, 3.55, 3.56, 3.57, 3.58, 3.59, 3.60, 3.61, 3.62, 3.63, 3.64, 3.65, 3.66, 3.67, 3.68, 3.69, 3.70, 3.71, 3.72, 3.73, 3.74, 3.75, 3.76, 3.77, 3.78, 3.79, 3.80, 3.81, 3.82, 3.83, 3.84, 3.85, 3.86, 3.87, 3.88, 3.89, 3.90, 3.91, 3.92, 3.93, 3.94, 3.95, 3.96, 3.97, 3.98, 3.99, 4.00, 4.01, 4.02, 4.03, 4.04, 4.05, 4.06, 4.07, 4.08, 4.09, 4.10, 4.11, 4.12, 4.13, 4.14, 4.15, 4.16, 4.17, 4.18, 4.19, 4.20, 4.21, 4.22, 4.23, 4.24, 4.25, 4.26, 4.27, 4.28, 4.29, 4.30, 4.31, 4.32, 4.33, 4.34, 4.35, 4.36, 4.37, 4.38, 4.39, 4.40, 4.41, 4.42, 4.43, 4.44, 4.45, 4.46, 4.47, 4.48, 4.49, 4.50, 4.51, 4.52, 4.53, 4.54, 4.55, 4.56, 4.57, 4.58, 4.59, 4.60, 4.61, 4.62, 4.63, 4.64, 4.65, 4.66, 4.67, 4.68, 4.69, 4.70, 4.71, 4.72, 4.73, 4.74, 4.75, 4.76, 4.77, 4.78, 4.79, 4.80, 4.81, 4.82, 4.83, 4.84, 4.85, 4.86, 4.87, 4.88, 4.89, 4.90, 4.91, 4.92, 4.93, 4.94, 4.95, 4.96, 4.97, 4.98, 4.99, 5.00, 5.01, 5.02, 5.03, 5.04, 5.05, 5.06, 5.07, 5.08, 5.09, 5.10, 5.11, 5.12, 5.13, 5.14, 5.15, 5.16, 5.17, 5.18, 5.19, 5.20, 5.21, 5.22, 5.23, 5.24, 5.25, 5.26, 5.27, 5.28, 5.29, 5.30, 5.31, 5.32, 5.33, 5.34, 5.35, 5.36, 5.37, 5.38, 5.39, 5.40, 5.41, 5.42, 5.43, 5.44, 5.45, 5.46, 5.47, 5.48, 5.49, 5.50, 5.51, 5.52, 5.53, 5.54, 5.55, 5.56, 5.57, 5.58, 5.59, 5.60, 5.61, 5.62, 5.63, 5.64, 5.65, 5.66, 5.67, 5.68, 5.69, 5.70, 5.71, 5.72, 5.73, 5.74, 5.75, 5.76, 5.77, 5.78, 5.79, 5.80, 5.81, 5.82, 5.83, 5.84, 5.85, 5.86, 5.87, 5.88, 5.89, 5.90, 5.91, 5.92, 5.93, 5.94, 5.95, 5.96, 5.97, 5.98, 5.99, 6.00, 6.01, 6.02, 6.03, 6.04, 6.05, 6.06, 6.07, 6.08, 6.09, 6.10, 6.11, 6.12, 6.13, 6.14, 6.15, 6.16, 6.17, 6.18, 6.19, 6.20, 6.21, 6.22, 6.23, 6.24, 6.25, 6.26, 6.27, 6.28, 6.29, 6.30, 6.31, 6.32, 6.33, 6.34, 6.35, 6.36, 6.37, 6.38, 6.39, 6.40, 6.41, 6.42, 6.43, 6.44, 6.45, 6.46, 6.47, 6.48, 6.49, 6.50, 6.51, 6.52, 6.53, 6.54, 6.55, 6.56, 6.57, 6.58, 6.59, 6.60, 6.61, 6.62, 6.63, 6.64, 6.65, 6.66, 6.67, 6.68, 6.69, 6.70, 6.71, 6.72, 6.73, 6.74, 6.75, 6.76, 6.77, 6.78, 6.79, 6.80, 6.81, 6.82, 6.83, 6.84, 6.85, 6.86, 6.87, 6.88, 6.89, 6.90, 6.91, 6.92, 6.93, 6.94, 6.95, 6.96, 6.97, 6.98, 6.99, 7.00, 7.01, 7.02, 7.03, 7.04, 7.05, 7.06, 7.07, 7.08, 7.09, 7.10, 7.11, 7.12, 7.13, 7.14, 7.15, 7.16, 7.17, 7.18, 7.19, 7.20, 7.21, 7.22, 7.23, 7.24, 7.25, 7.26, 7.27, 7.28, 7.29, 7.30, 7.31, 7.32, 7.33, 7.34, 7.35, 7.36, 7.37, 7.38, 7.39, 7.40, 7.41, 7.42, 7.43, 7.44, 7.45, 7.46, 7.47, 7.48, 7.49, 7.50, 7.51, 7.52, 7.53, 7.54, 7.55, 7.56, 7.57, 7.58, 7.59, 7.60, 7.61, 7.62, 7.63, 7.64, 7.65, 7.66, 7.67, 7.68, 7.69, 7.70, 7.71, 7.72, 7.73, 7.74, 7.75, 7.76, 7.77, 7.78, 7.79, 7.80, 7.81, 7.82, 7.83, 7.84, 7.85, 7.86, 7.87, 7.88, 7.89, 7.90, 7.91, 7.92, 7.93, 7.94, 7.95, 7.96, 7.97, 7.98, 7.99, 8.00, 8.01, 8.02, 8.03, 8.04, 8.05, 8.06, 8.07, 8.08, 8.09, 8.10, 8.11, 8.12, 8.13, 8.14, 8.15, 8.16, 8.17, 8.18, 8.19, 8.20, 8.21, 8.22, 8.23, 8.24, 8.25, 8.26, 8.27, 8.28, 8.29, 8.30, 8.31, 8.32, 8.33, 8.34, 8.35, 8.36, 8.37, 8.38, 8.39, 8.40, 8.41, 8.42, 8.43, 8.44, 8.45, 8.46, 8.47, 8.48, 8.49, 8.50, 8.51, 8.52, 8.53, 8.54, 8.55, 8.56, 8.57, 8.58, 8.59, 8.60, 8.61, 8.62, 8.63, 8.64, 8.65, 8.66, 8.67, 8.68, 8.69, 8.70, 8.

3.17 3.16 3.15 3.14 3.13 3.12 3.09C 3.09B 3.07

3.18 3.19 3.20A 3.20B 3.20 3.21 3.22 3.10C 3.10B 3.10A 3.03 3.02 3.01 3.04 3.05

3.65 3.64A 3.64 3.62 3.63 3.61 3.61B 3.55 3.56 3.51A 3.51B 3.52 3.53 3.54 3.50 3.49 3.48 3.45 3.44A 3.44B 3.47 3.46 3.42 3.43 3.41 3.42A 3.42B 3.86 3.85 3.83C 3.83B 3.83A 3.83 3.82 3.81 3.80 3.79 3.77 3.76 3.75 3.74 3.73 3.72 3.71

2 Elevator

6 Event space

Coffee corner

- Study and project spaces
- Practice spaces (workplaces, labs, lectorates)
- Educational spaces (classrooms, lecture halls)
- Staff spaces (team room, consultation room)
- Other spaces

4TH FLOOR

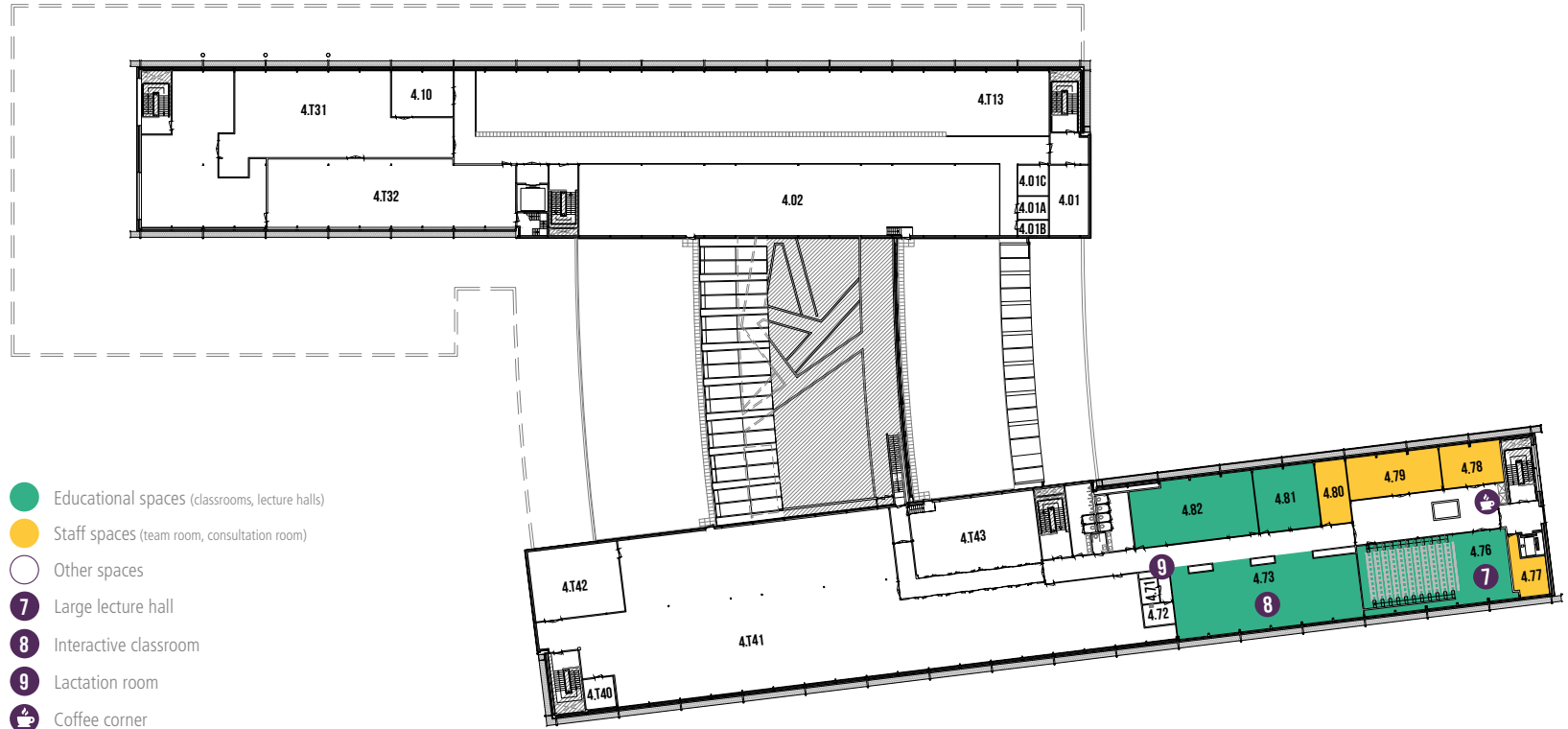

8

SIGNING

For the first time in the Rndom?

You will quickly find your way using the information kiosks and information signs. Here you can see what they look like, so you can quickly recognize them in the building.

Information kiosk entrance

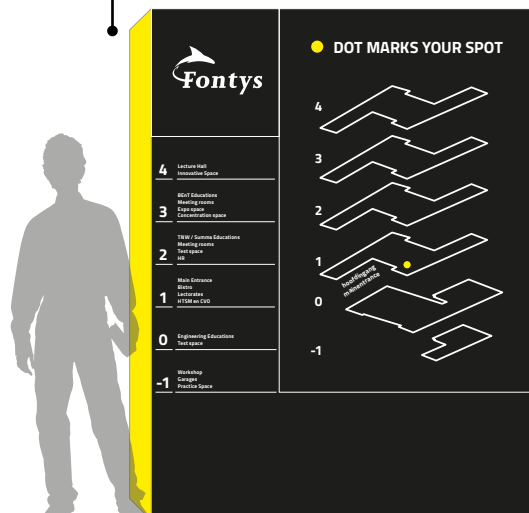

Example information kiosk on the floors

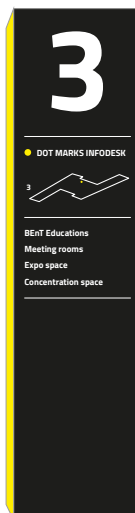

These signings show you the way to our spaces and classrooms.

With these signings you can find your way at the elevator or stairs.

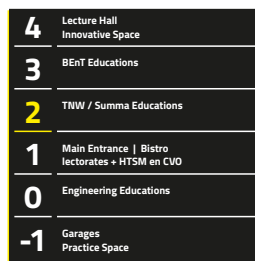

With these signings we show you where f.e. the elevators and restrooms are.

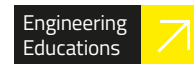

IMPORTANT CONTACT

Facility team ER

The Service & Information point on the first floor
(to the right of the main entrance)

henf-rondom@fontys.nl

Also check the portal of your own
institute regularly. All the frequently
asked questions and answers are
listed there.

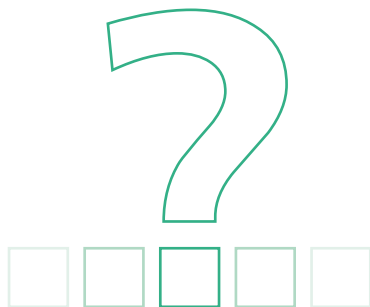

QUESTIONS? IMPORTANT CONTACT DETAILS

12



HOGESCHOOL
ENGINEERING



HOGESCHOOL
BEDRIJFS-
MANAGEMENT,
EDUCATIE EN
TECHNIEK



HOGESCHOOL
TOEGEPASTE
NATUUR-
WETENSCHAPPEN